

\\TCGEBFILES\SERVER\Proj\10642874 - Sleepy Hollow Estates-Phase 2 - Camden - NC\DWG\Sheet\2874\Cprelim.dwg | Plotted on 2/20/2019 11:35 AM | by Kim Hamby



Know what's below.
Call before you dig.

SITE DATA:

- OWNERSHIP:
DANIEL CLAY CARTWRIGHT
382 NORTH GREGORY RD
SHAWBORO, NC 27973
PH: 252-202-6645
- SITE INFORMATION:
PENDING RECORDATION OF REVISED BOUNDARY SURVEY.

PIN: 028935012881690000
SUBDIVISION AREA: 14.57 AC
ZONING: NR (NEIGHBORHOOD RESIDENTIAL)
EXISTING USE: VACANT
PROPOSED USE: RESIDENTIAL

PROPOSED LOTS: 10
MINIMUM LOT SIZE: 40,000 SQ. FT.

R 2 BUILDING SETBACKS:
50' FRONT
10' SIDE
10' REAR
- THIS SITE IS LOCATED IN FLOOD ZONES "X", "SHADED X", AND "AE(1)" ACCORDING TO THE FEMA FLOOD MAPS 3720892800K, DATED DECEMBER 16, 2005 AND 3720893500U, DATED DECEMBER 21, 2019. FLOOD ZONES ARE SCALED FROM F.I.R.M. FLOOD ZONES ARE SUBJECT TO CHANGE.
- THERE ARE NO WETLANDS LOCATED WITHIN THE PROJECT AREA.

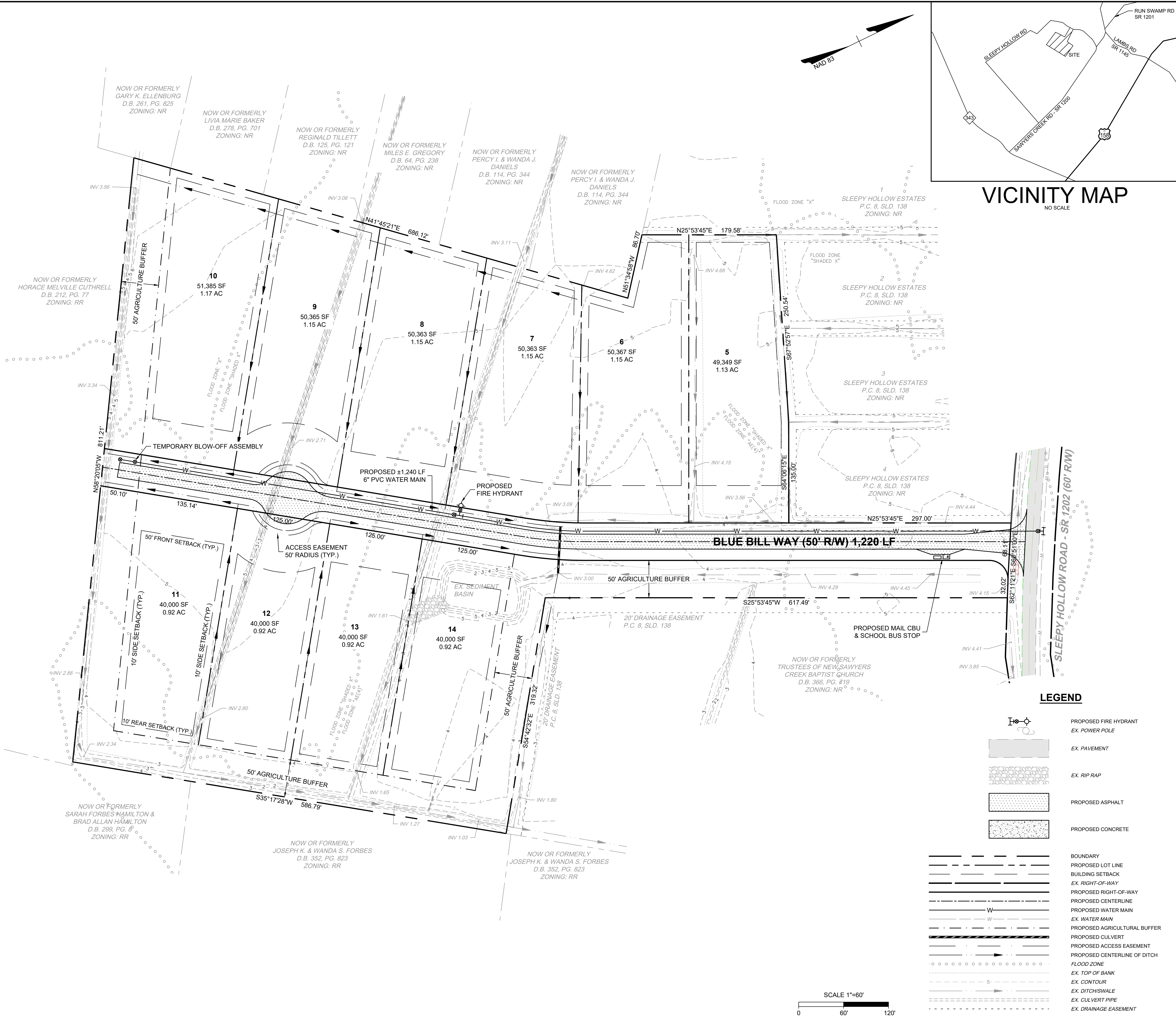

SCALE 1"=60'

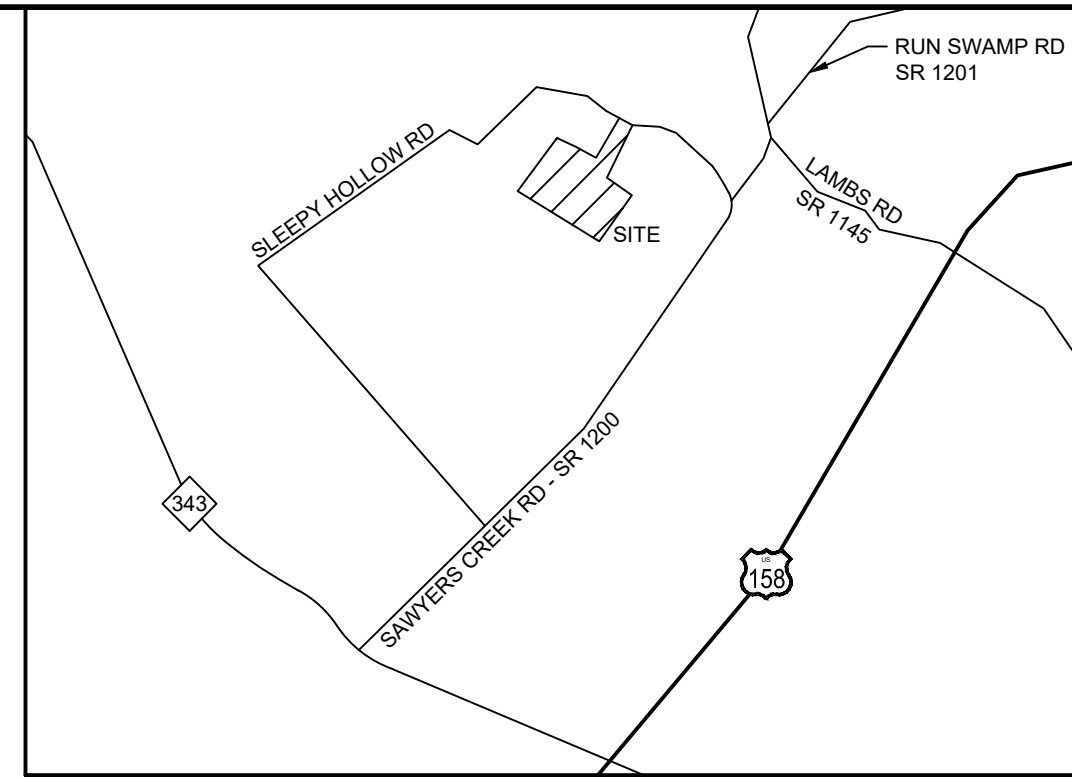

VICINITY MAP
NO SCALE

LEGEND

- PROPOSED FIRE HYDRANT
- EX. POWER POLE
- EX. PAVEMENT
- EX. RIP RAP
- PROPOSED ASPHALT
- PROPOSED CONCRETE
- BOUNDARY
- PROPOSED LOT LINE
- BUILDING SETBACK
- EX. RIGHT-OF-WAY
- PROPOSED RIGHT-OF-WAY
- PROPOSED CENTERLINE
- PROPOSED WATER MAIN
- EX. WATER MAIN
- PROPOSED AGRICULTURAL BUFFER
- PROPOSED CULVERT
- PROPOSED ACCESS EASEMENT
- PROPOSED CENTERLINE OF DITCH
- FLOOD ZONE
- EX. TOP OF BANK
- EX. CONTOUR
- EX. DITCH/SWALE
- EX. CULVERT PIPE
- EX. DRAINAGE EASEMENT

PROGRESS PRINT
FEB 20, 2019
NOT FOR
CONSTRUCTION

THIS DRAWING PREPARED AT THE
ELIZABETH CITY OFFICE
1805 West City Drive, Unit E | Elizabeth City, NC 27909
TEL 252.621.3030 FAX 252.392.6594 www.timmons.com

YOUR VISION ACHIEVED THROUGH OURS.

REVISION DESCRIPTION	

DATE	
02/20/19	
DRAWN BY	JHS
DESIGNED BY	KDH
CHECKED BY	KDH
SCALE	1" = 60'

TIMMONS GROUP

NORTH CAROLINA LICENSE NO. C-1652

SLEEPY HOLLOW ESTATES - PHASE 2

COURTHOUSE TNSP - CAMDEN COUNTY - NORTH CAROLINA

PRELIMINARY PLAT

JOB NO.
42874
SHEET NO.
S1.0

These plans and associated documents are the exclusive property of TIMMONS GROUP and may not be reproduced in whole or in part and shall not be used for any purpose whatsoever, inclusive, but not limited to construction, bidding, and/or construction staking without the express written consent of TIMMONS GROUP.